



SUBMITTAL FORM P-156 Exposed Pipe Angle Sill Faucet



Find us in
MasterSpec[®]
a product of The American Institute of Architects

JOB NAME

JOB LOCATION

PART NO#

ARCHITECT

ENGINEER

CONTRACTOR



■ FEATURES

- P-156, P-256 and P-356 have a P-002 vacuum breaker backflow check valve approved under ASSE 1011
- P-166, P-266, and P-366 have a P-004 vacuum breaker backflow double check valve approved under ASSE 1052
- 3/4" FPT inlet option on top and bottom for flexibility during installation
- Includes brass plug for easy close-off and 'drain down' for the system
- Integral shut off allows valve to be shut off and serviced without shutting off entire system
- Powder coated aluminum metal handle or loose key options
- Easy to install - no need for additional brackets
- Direct surface mount for exposed pipe

Certifications

- ASSE 1011
- ASSE 1052
- C-UPC
- CSA B64.2

■ PART NUMBER

P-156NP.75

Operator

- 1- Handle
- 2- Loose Key
- 3- Handle & Loose Key

Vacuum Breaker

- 5- P-002 ASSE 1011
- 6- P-004 ASSE 1052

Finish

NP- Satin Nickel Plated

Inlet

3/4" FPT

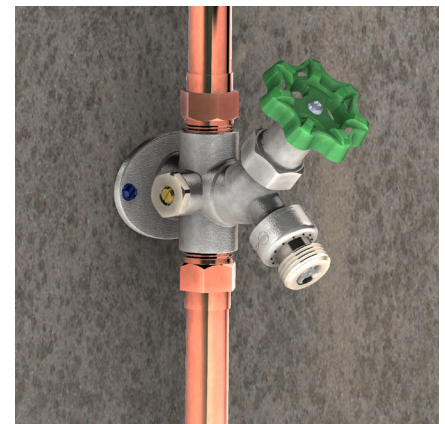



SUBMITTAL FORM

P-156 Exposed Pipe Angle Sill Faucet

■ MATERIALS

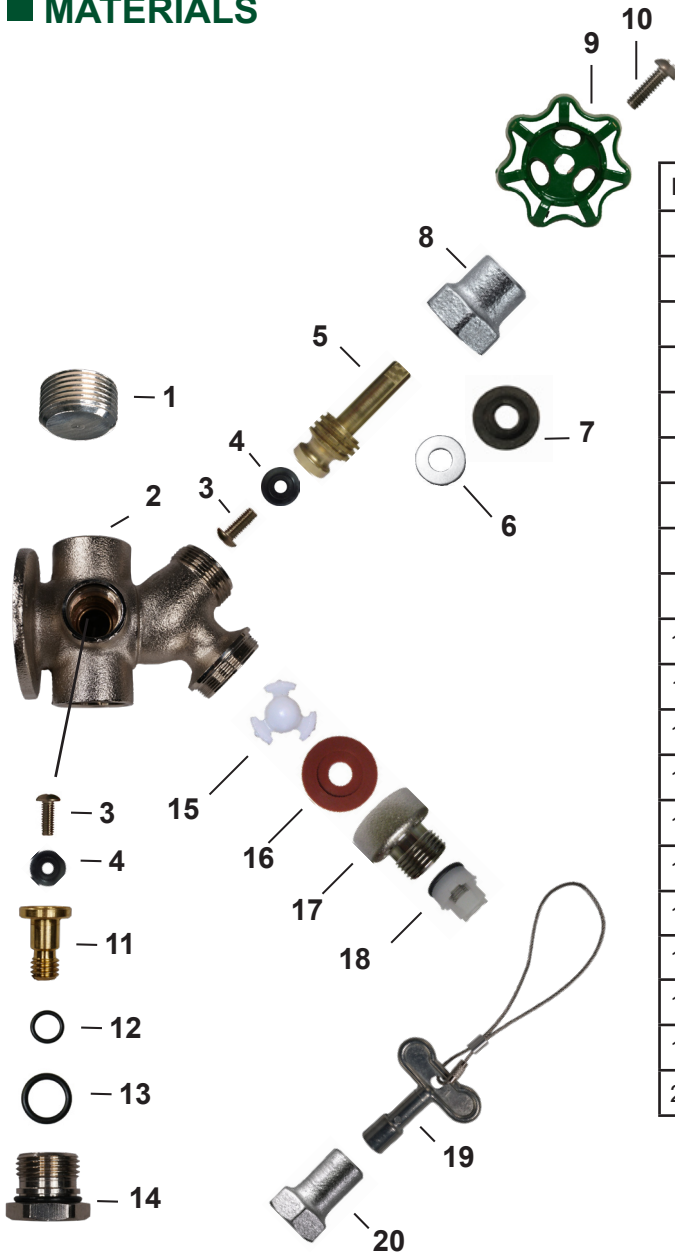

ID	PART	MATERIAL
1	Plug	Satin Nickel Plated Brass
2	Body	Satin Nickel Plated Brass
3	Screw	Stainless Steel
4	Seat Washer	EPDM
5	Stem Body	Brass
6	Washer	Stainless Steel
7	Packing	Graphite
8	Valve Stem Cap	Brass
9	Handle	Powder Coated Aluminum
10	Screw	Stainless Steel
11	Integral Stop Stem	Brass
12	O-Ring	EPDM
13	O-Ring	EPDM
14	Integral Stop Nut	Satin Nickel Plated Brass
15	Check Spider	Acetal
16	Stepped Washer	Silicone
17	Hose Piece	Satin Nickel Plated Brass
18	Check Valve	Composite
19	Loose Key	Aluminum
20	Extended Valve Stem Cap	Brass

■ SPECIFICATIONS

Furnish and install Model P-156 / 256 / 356 / 166 / 266 / 366 (choose one) Exposed Piping Angle Sill Faucet as manufactured by PRIER Products Inc. Angle Sill Faucet shall be surface mounted and installed using female pipe thread inlet connections.

Angle Sill Faucet should be designed for direct surface mounted of exposed piping. It should contain an integral shut off to service valve without shutting off system water and have a through valve connection for installation in series. Flow rate shall be a minimum of 7 gallons per minute at 25 psi differential pressure and be at full flow in a single handle rotation. Angle Sill Faucet shall have 3/4" garden hose outlet connection with dual 3/4" FPT inlet connections. A plug shall be provided with each valve for endpoint connections. Angle Sill Faucet should feature solid brass body, non-ferrous materials and satin nickel plating.