



Build With Purpose

SUBMITTAL FORM P-RH3 Mild Climate Roof Hydrant



Find us in

MasterSpec

a product of The American Institute of Architects



JOB NAME

JOB LOCATION

PART NO#

ARCHITECT

ENGINEER

CONTRACTOR

FEATURES

- With integral P-004 vacuum breaker and dual backflow preventer
- Adjustable bracket to accommodate roof angles up to 2/12 pitch
- Mounts to any roof structural member (truss, I-beam, concrete roof, or other)
- 3/4" garden hose threads standard

Certifications

- ASSE 1052
- C-UPC
- CSA B64.2
- ASME B1.20.1

PART NUMBER

P-RH3

H3- Mild Climate Roof Hydrant
Includes Roof Hydrant Mounting Bracket

DIMENSIONS

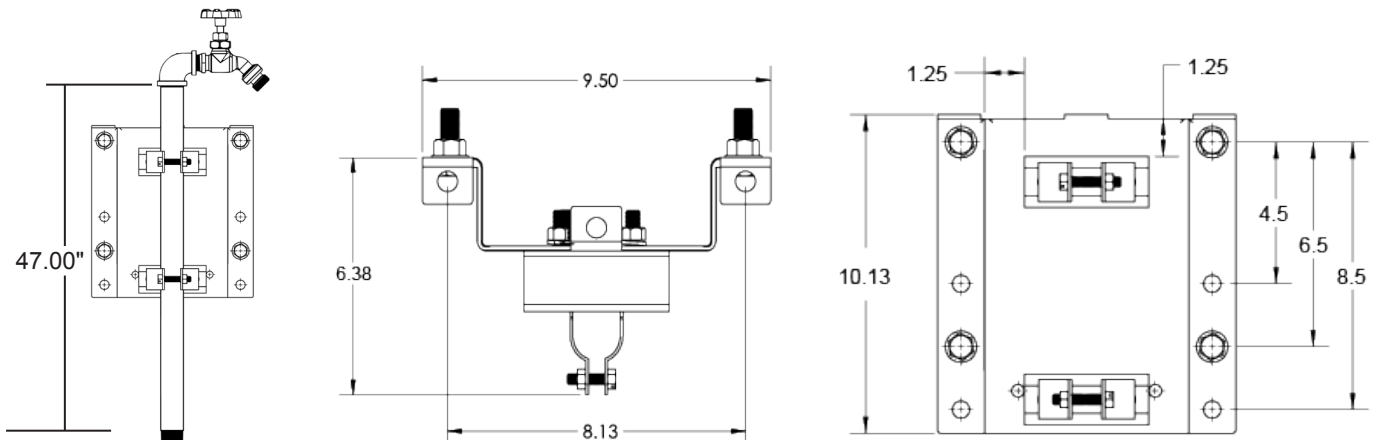



Build With Purpose

SUBMITTAL FORM P-RH3 Mild Climate Roof Hydrant

MATERIALS

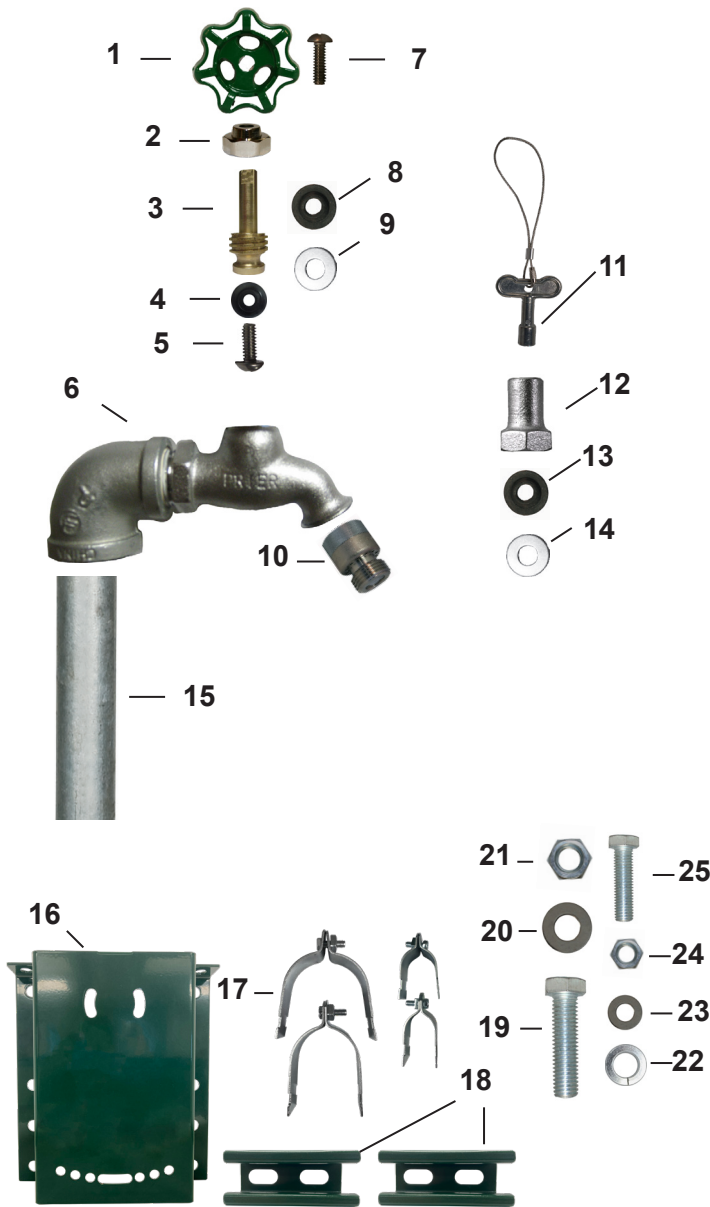

ID	PART	MATERIAL
1	Handle	Aluminum
2	Valve Stem Cap	Brass
3	Stem Body	Brass
4	Seat Washer	EPDM
5	Screw	Stainless Steel
6	Body	Brass
7	Screw	Stainless Steel
8	Stem Packing	Graphite
9	Packing Washer	Stainless Steel
10	ASSE 1052 VB & Backflow Check Valve	See Below
	Hose Piece	Brass
	Adapter	Brass
	Washer	Silicone
	O-Ring	EPDM
	Check Spider	Acetal
	Check Valve	Composite
11	Loose Key	Zinc and Aluminum
12	Valve Stem Cap	Brass
13	Stem Packing	Graphite
14	Packing Washer	Stainless Steel
15	Pipe	Galvanized Steel
16	Mounting Bracket	Powder Coated Steel
17	1" Pipe Clamp Assembly for P-RH1, P-RH2, P-RH3	Zinc Plated Steel
17	2 1/2" Pipe Clamp Assembly for P-RH4	Zinc Plated Steel
18	Unistrut Steel Struts	Powder Coated Steel
19	1/2" Mounting Bolt	Zinc Plated Steel
20	1/2" Flat Washer	Zinc Plated Steel
21	1/2" Mounting Nut	Zinc Plated Steel
22	3/8" Lock Washer	Zinc Plated Steel
23	3/8" Flat Washer	Zinc Plated Steel
24	3/8" Hex Nut	Zinc Plated Steel
25	3/8" Bolt	Zinc Plated Steel

SPECIFICATIONS

Furnish and install Model P-RH3 Commercial Post Mount Roof Hydrant manufactured by PRIER Products, Inc. Hydrant shall be installed through a 1 3/4" single penetration in the roof and mounted to the interior structure with the Universal Roof Hydrant Mounting Bracket (P-RMB) provided. This bracket must be manufactured of heavy gauge powder coated steel and must allow for adjustment to meet roof angles up to 2/12 pitch. The mounting bracket shall be mounted to concrete, a roofing truss, steel I-beam or interior wall with standard construction materials (threaded rod, Unistrut or other). The hydrant shall have an integral vacuum breaker/backflow preventer and be approved under the ASSE 1052 standard. The hydrant head shall have a 3/4" inlet and be made of brass with a satin nickel chromium finish. The roof penetration is to be sealed by the roofing contractor in accordance with the roofing codes and conditions in their municipality.